



# Dolphin Yachts

INTERNATIONAL YACHT BROKERS

Dolphin Yachts S.L.

Club de Mar

07015 Palma de Mallorca

Spain

info@dolphin-yachts.com

---



## Camper & Nicholson's Classic

<b>Constructor:</b>	Camper & Nicholson's	<b>Eslora total:</b>	34.50m (113'2")
<b>Modelo:</b>	Classic	<b>Manga:</b>	5.46m (17'9")
<b>Año:</b>	1933	<b>Calado:</b>	2.90m (9'5")
<b>Material:</b>	Madera	<b>Combustible:</b>	2.518 Litres
<b>Distribución:</b>	7 berths in 3 cabins	<b>Agua:</b>	3.280 Litres
<b>Arquitecto:</b>	Charles Nicholson	<b>Motores:</b>	1 x 360hp MAN
<b>Desplazamiento:</b>	107000 kg	<b>Quilla:</b>	Long

1.100.000 € IVA exento



**MOTORES:**

1 x 360hp MAN (2014)

Horas Motor: 1900 aprox.

**VELOCIDAD:**

12 knots aprox.

**AUTONOMÍA:**

1200 nautical miles

**CAPACIDADES:**

Combustible: 2518 Litres

Agua: 3280 Litres

Aqua negras / grises: 500 Litres

**EQUIPO MECÁNICO:**

MAN diesel engine (2014) Consumption at 10 knots 17 litres/hour.

Hundersted 4-blade prop with variable pitch

Double ram hydraulic steering (1998)

Fuel capacity: 4 tanks (2,518 litres in total)

Water capacity: 6 tanks in s/steel (3,280 litres in total)

Grey water: 500 litres (with automatic/manual discharge)

Black water: 320 litres (with manual discharge)

12V/24V/220V including shore supply

10 Batteries 210Ah (2023)

12V/24V DC lighting & instruments

24V/220V sockets in all cabins, including toilets.

22V/110V shaving sockets in heads.

2 x Victron 80A chargers

2 x Victron 850W invertors

Kohler 3-phase night generator (1994) with own 12V starter battery

Perkins Sabre 25kW 3-phase generator with own 12V starter battery

5kW/220V mono-phase travel power driven from main engine (2012)

Watermaker 220 litres/hour

Hot water tank/calorifier 100 litres (2014)

Dual freshwater pressure pumps with hydro cells 24V (3)

Main reverse cycle air conditioning with independent air handlers in each cabin all thermostatically controlled.

**DISTRIBUCIÓN:**

Berths: 7

Cabins: 3

Head: 3

Crew Berths: 6

Crew Cabins: 2

The accommodation of SAHARET is a particular feature of the vessel and includes much of the original period joinery and paneling in polished walnut and teak. The lower saloon with the ambience of a gentleman's club adjoins the master en-suite stateroom and can be closed off to provide a private suite. The deck-saloon, bright and airy is a particularly pleasant place to socialise, enjoy a good book and admire the scenery. In total SAHARET has three en-suite double cabins, plus two further separate crews' cabins and in total berths for thirteen.

In more detail, the accommodation affords:

Master cabin

Very spacious cabin, fully carpeted with white enamel, varnished teak trim, teak doors & drawers. Full



size double bed, large hanging wardrobe & drawers, dressing table, chair, glass cabinets & book shelves. Large skylight above. En-suite designed with Corian (2014), shower, wash basin & electric Superflush toilet, with plenty of storage lockers, etc.

#### First guest cabin

Two single beds, book shelves, wardrobe & drawers to starboard side. En-suite designed in Corian (2014), shower, wash basin & electric Superflush toilet, with plenty of storage space.

#### Second guest cabin

Double bed, plus additional single bunk bed, with wardrobe & drawers to port side. En-suite designed in Corian (2014), shower, wash basin & electric Superflush toilet, with plenty of storage space.

#### Lower saloon

L-shaped settee with cocktail cabinet, French polished panels of walnut & beveled glass cabinets, large skylight above. Extra convertible single bed with separating curtain. Double doors can separate this area from the rest of accommodation, leaving it en-suite with master cabin, if desired.

#### Deck saloon

Settees surround teak dining table with built in bar area, stereo unit, Mini-M extension & VHF Sailor sub-station, Vestel flat screen LCD TV and Vestrel DVD player (2012).

#### **EQUIPO DE INTERIORES:**

Fitted carpets throughout guest accommodation

Vestel LCD flat screen plus DVD player

CD/radio stereo system (captain's cabin)

CD/radio stereo system (crew mess)

Pioneer CD stacker, tape/radio stereo unit with outside speaker connections (saloon)

#### **COCINA/LAVANDERÍA:**

4-Burner gas cooker with Smeg electric oven (2014)

Rowenta electric microwave with rotisserie

Fridges 24V (2)

Isostar domestic style fridge/freezer

Chest freezer 10 ft<sup>3</sup> (2014)

Fridge/freezer in other accommodation areas (3)

Icemaker (2013)

Bosch dryer (2007)

Bosch washing machine (2014)

#### **NAVEGACIÓN:**

All Raymarine navigation equipment (2009/2012)

Raymarine E120 chart plotter (cockpit)

Raymarine E80 chart plotter (below)

Garmin Plotter

Raymarine ST60+ compass (cockpit)

Raymarine ST60+ Tridata (below)

Raymarine ST60+ graphic (below)

Raymarine ST60+ graphic (cockpit & below)

Raymarine ST60+ wind (cockpit)

Raymarine ST60+ CH wind (cockpit)

Raymarine 48nm radome antenna interfaced to plotters.

Raymarine DSC VHF radio (2023)

Simrad IS12 data marine instrument (independent system)

Sailor mini-telephone system (1998)

Furuno video depth sounder

Furuno Navtex NX300



Furuno autopilot with remote control (1998)  
Sestral hand bearing compass.  
Phoncom 8 Station Intercom system  
Meteoliner baroscope (1999)

#### EQUIPO DE CUBIERTA:

CQR 105lbs anchors (2)  
Kedge 80lbs folding fisherman anchor.  
Lofrans gypsy anchor windlass (port)  
Capstan gypsy anchor windlass (stb)  
Galvanized oval link chain 0,5 inch  
Torkmaster electric/hydraulic warping capstan 24V  
Anchor wash 24V  
Teak bathing ladder  
Alloy folding teak passerelle  
Deck teak dining table containing cooking gas cylinders (4) & storage space.  
Fenders, ropes & warps  
Sun awnings & side curtains  
Deck stools (2), ample deck cushions on coach roof top for lounging  
Canvas covers for all exposed varnished surfaces, plus winter covers for masts and booms.

#### JARCIA Y VELAS:

Ketch - Spars & Rigging Bermuda ketch rig with Profurl roller furling for jib (2014) Aluminium running poles (2) on mast tracks with twin running sails. Masts in Columbian pine by Spencer (1992) Bowsprit (1986) & Mizzen boom (1988) Stainless steel running & standing rigging (1 x 19) by Spencer Stainless steel & chromed bronze bottle screws (1992) Shroud plates s/steel (1986) Sails 1 x 1173 sqft. mizzen staysail, very good condition (1988) 1 x 1800 sqft. Ratsey & Lapthorne main sail, good condition (2000) 1 x 552 sqft. Doyle Italy mizzen (2014) 1 x 759 sqft. Doyle Italy furling jib (2014) 1 x 390 sqft. jib topsail, good condition 1 x Doyle main staysail (2014) Symmetric spinnaker for use without a pole (2023) Anderson sheet winches (6) (1998) 2 runner Anderson winches (2014)

#### SEGURIDAD:

Automatic bilge pump 24V  
Manual/electric high-capacity bilge pump 24V  
2-Phase high-capacity bilge pump 220V  
Lalizaz 6-man life rafts (2) (2020)  
Life rings (2)  
Horseshoe buoys with lights (2)  
Inflatable life jackets (12)  
Halon fire extinguisher externally operated (engine room)  
Belt driven fire pump (main engine)  
Additional fire extinguisher throughout ship (7)  
Full set of flares  
EPIRB with automatic float release (2012)  
Emergency tiller

#### ANEXOS/JUGUETES:

Inflatable 3,50m tender (2013)  
Zodiac 4m RIB (hull from 2016)  
Yamaha 25hp outboard (2013)  
Yamaha 40hp outboard (2013)

#### HISTORIAL DE MANTENIMIENTO:

Built in 1933 by Camper & Nicholson, designed by Charles Nicholson in steel composite construction. All teak superstructure & planking. Backbone of English oak. Bronze fastened.  
Originally constructed to Lloyds 100A1 Class



Rebuilt in 1985/86, major refit in 1998/99 including new teak deck, new deck saloon & wheel box. 2013/2014 underwent major winter refit including engine room, all tanks and plumbing, bilges and general refurbishment.

Masts and the bowsprit removed and repaired (2020)

Shaft and propellor service (2021)

Net / Gross Tonnage: 46.13 / 56.62 tons

Displacement: 107 tons

## COMENTARIO DEL AGENTE:

The first owner of SAHARET OF TYRE, this Classic 114 FT Camper & Nicholsons Ketch, was an American who built her to fulfil two passions - sailing and buying antiques from all over the Mediterranean. In 1986 she was totally stripped down to bare frames and rebuilt from the keel up. Wiring, plumbing, accommodation, tanks, etc., were all new. In 1998 a further major refit was carried out, renewing the ship's decks down to the beams - 1-inch marine ply with 1,25-inch solid teak on top. A new deck saloon with a higher bulwark and wheel box, designed more in keeping with the vessel's period, were fitted. Her rigging configuration was brought back to original. Additional framing and stringers were added to beef up the boat, adding more strength to the hull. Windlass, chains, winches and steering gear together with various navigation aids, replaced the old. Stainless steel water tanks were renewed, and a black water tank added. In 2013/2014 Saharet underwent another major refit and continued to be updated and maintained, both, technically and aesthetically, by her meticulous owner and same captain for over 30 years to the highest standard possible. Her present owner after several years preparation with the help of the previous Captain is currently realizing his dream to cross the Atlantic and enjoy sailing in the Caribbean in 2024. Viewing of this very sound, strong and fast yacht in very good condition is highly recommended!

## LUGAR:

Caribbean





## Plan de la distribución

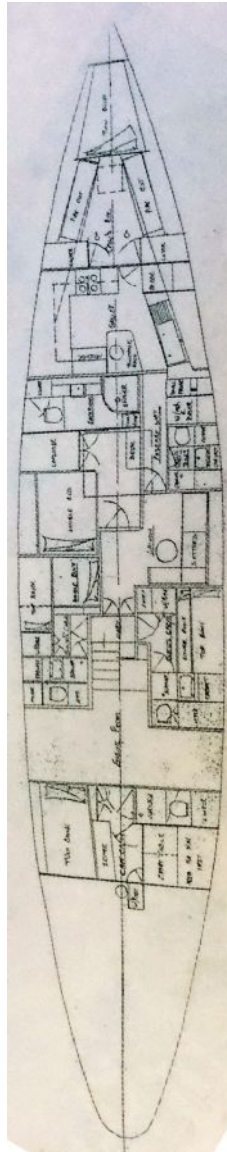

Las informaciones presentados en esta descripción son probablemente correctas pero su exactitud no esta garantizada y no podrán ser utilizados contractualmente. Una peritación independiente es siempre recomendable. Este barco puede ser retirado de la venta sin previo aviso.