



Dolphin Yachts

INTERNATIONAL YACHT BROKERS

Dolphin Yachts S.L.

Club de Mar

07015 Palma de Mallorca

Spain

info@dolphin-yachts.com



Frederikssund Gaff Schooner

Hersteller:	Frederikssund	LüA:	38.00m (124'7")
Modell:	Gaff Schooner	Breite:	7.00m (23'0")
Jahr:	1930	Tiefgang:	3.70m (12'1")
Rumpfmateriail:	Teak/Iroko	Treibstoff:	4.500 Litres
Räumlichkeiten:	10 berths in 5 cabins	Wasser:	6.000 Litres
Designer:	Wedell-Wedellsborg	Motoren:	1 x 318hp Scania
Verdrängung:	130 tonnes	Keel:	Long

1.250.000 € MwSt bezahlt



MOTOREN:

1 x 318hp Scania D19 44m 6 cyl. Turbo

GESCHWINDIGKEIT:

9 knots aprox.

FASSUNGSVERMÖGEN:

Treibstoff: 4500 Litres

Wasser: 6000 Litres

Abwasser: 1500

MECHANISCHE AUSRÜSTUNG:

Sidepower Bow thruster SP550HYD/U-37 with Joystick control at steering station

Generators: 1 x 24kw in sound shield box 1 x 17.5kw in sound shield box

Chargers-: 2 x Victron 100Amp Skylla TG 24/100 autom charger for start + service sets

Shorepower intakes 220V in aft peak complete with cable

2- way plug system separately for aircon - ship shore cables 12 +15m with waterproof plugs

Batteries: All from 2025

Start set ME 2 x gel +-200Ah

Start set 24 Kw generator 1 x 12v gel +-100Ah

Start set 17.5Kw generator 1 x 12v gel +-100Ah

Service set 2 x 24v a x 800Ah

Steering Gear John Hastie & Co Greenock - original 1930 built in bronze

Gearbox - twin disk hydraulic model nr. MG-5091 reduction 1:2.95 installed separate oil colling heat

exchangers and flexible coupling

Stainless steel type 316 prop shaft

Twin Racor fuel filters

Hot water boiler 120l 2025

RÄUMLICHKEITEN:

Berths: 10

Cabins: 5

Head: 5

Crew Berths: 7

Crew Cabins: 3

Very spacious and comfortable layout, ideal for charter, offering optimal privacy with fully separate crew quarters located forward and divided from the guest areas by a centrally positioned galley. The interior is beautifully crafted in the renowned, richly detailed classic and elegant style, designed by Donald Starkey featuring finely selected mahogany, bevelled glass mirrors, and high-quality brass and stainless-steel fittings and hardware.

The yacht boasts varnished teak floors, varnished mahogany countertops, and tiled bathroom walls, complemented by Villeroy & Boch sinks.

She features a large saloon with a corner bar, a dining area, and a fireplace.

Master cabin with queen size bed of +-200cm length with ensuite bathroom including a bathtub.

VIP double cabin with ensuite bathroom and separate shower

Double cabin /library with ensuite bathroom and separate shower

Two comfortable cabins each offering 2 single bunk berths and each with ensuite bathroom and separate shower

Accommodates 10 guests in five cabins, with one cabin being a library that converts into a double en-suite cabin.

INNENAUSSTATTUNG:

Open fire look alike electric heaters in salon and library for comfortable hot air

Actana electric freshwater flush toilets



KOMBÜSE/WASCHKÜCHE:

4- ring induction hob 2025

Electric oven

Panasonic Microwave NN SD278S

Whirlpool hood

Siemens dishwasher

NAVIGATION:

Silva Depthsounder

Danforth Compass

Furuno VHF

Plastimo handheld VHF

DECK:

Winches Specially built Meissner electric winches, cast bronze to an old model -6 Meissner CMB

36E-classic electric single speed winches 2003

1 Lofrans Super Ercole 3500w Capstan

1 x 240Kg stell anchor with 120m of galvanized steel chain

Teal deck 2004

6 Prisma model deck built in deck lights

SPIEREN, RUNDHÖLZER & SEGEL:

Lower masts in Aliminium with Oregon pine trim Masts keel stepped spreader lights and up sail lights

Mast tops in massive laminated Oregon pine Oregon Pine mainsail booms and bowsprit Standing rigging

: stainless steel +galvanized wire with stainless steel and galvanized turnbuckles. in 2017 forward stay

and birds stay replaced. Furling system fir halfwinder Sheets and halyards cockpit, aftdeck and mast

controlled - may lines renewed in 2018 Traditional wooden blocks Stainless steel 316 + aluminium +

bronze + glavanised steel fittings and hardware Sails from 2005 in Dacron by Doyle USA: Main Sail 195

sq m Schooner sail 94 sq m Schooner Topsail 29 sq m Jib 63 sq m Top flying Jib 27 sq m

SICHERHEIT:

10 x portable fire extinguishers

FM 2000 automatic fire extinguishing system in ER

Fire/smoke detectors in cabins

Fire fighting pump

Marinelee SIRRAH fire detection system

WARTUNGSGESCHICHTE UND BAUWEISE:

Originally built to Lloyds 16A1

Rebuilt to Norske Veritas 100A1 - expired

2003-2005 Restoration at Navcon Shipyard Germany

- New deck fittings
- New chain plates
- New 316L Stainless steel inserted in the hull, including stainless steel longitudinal reinforcement stringer
- New rudder, rudder stock and stern tube
- New propeller and propeller shaft
- All new electronic equipment
- New electrical system, including cables, switchboards, etc
- New plumbing system, including pipes, tank and pump
- New bilge pump system
- New fire-fighting system
- Fire integrity insulation of engine room
- New fire detection system in each cabin
- New bowsprit, lower main mast, lower foremast with inner reinforcement of aluminium, booms and gaffs



- Parts of rigging not in perfect condition renewed
- Keel bolts in bronze inspected and found to be in perfect condition
- Sails renewed in clipper cream canvas by Doyle US

2017 Restoration

- 2 new top masts in Douglas Fir installed and all rigging inspected
- Full bimini covers with side curtains
- New sail covers
- 2 x 8-person life rafts

10/2025 Hull service including bowthruuster service.

ANMERKUNGEN DES MAKLERS:

Originally built in 1930 at the Frederikssund Skibsvaerft shipyard in Denmark, this remarkable twin mast topsail schooner was commissioned by the Olympic champion and Magasin du Nord owner Wilhelm Vett. Designed by Baron Ernst Gustav Wedell-Wedellsborg, architect to King Christian X of Denmark of the 10m-class yacht Rita VI.

At the end of the 1930s, she was acquired by shipping magnate Ivar Lauritzen, who remained her custodian until the early 1970s. Her next owner, American yachtsman George Riffe, sailed and chartered her with his family throughout the Caribbean and the South of France.

She was later purchased by Mikael Krafft, owner of the renowned Star Clippers fleet, who undertook a multimillion-euro restoration that returned her to near-new condition in 2005. The project, carried out by A. Lindholm Naval Architects in collaboration with award-winning interior designer David Starkey, was recognised as a finalist in the refit category of the 2006 World Superyacht Awards.

Today, this 38m classic twin-masted schooner represents a rare opportunity to acquire a true maritime treasure. Built in Denmark in 1930, she combines heritage craftsmanship with refined comfort. Her high-gloss mahogany interior accommodates up to 10 guests in 5 elegant cabins, complemented by modern amenities and technical upgrades, including a powerful hydraulic bow thruster, modern anchoring system, automatic deck winches, and aluminium masts clad in wood to preserve her timeless aesthetic.

Dimensions:

- 30.7m on deck
- 37m including bowsprit
- 38.6m overall

STANDORT:

France





Grundriss

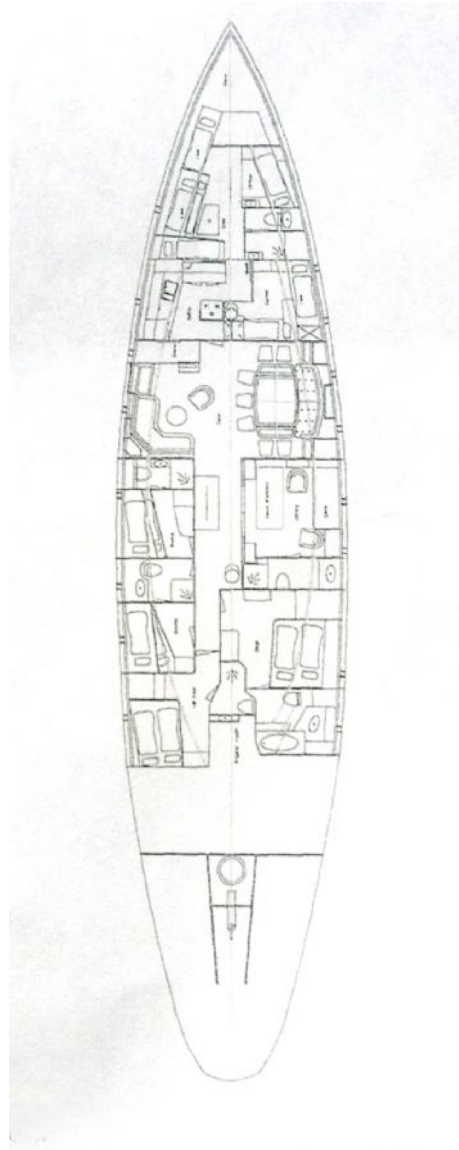

Die Angaben in dieser Beschreibung werden als korrekt angenommen, ihre Exaktheit ist jedoch weder garantiert noch können sie als Vertragsbestandteil genutzt werden. Ein unabhängiges Gutachten ist immer empfehlenswert. Dieses Schiff wird angeboten unter Vorbehalt von Zwischenverkauf, Preisänderung oder Angebotsrücktritt ohne Mitteilung.