



Dolphin Yachts
INTERNATIONAL YACHT BROKERS

Dolphin Yachts S.L.

Club de Mar

07015 Palma de Mallorca

Spain

info@dolphin-yachts.com



Voyage 580

Hersteller:	Voyage	LüA:	17.55m (57'6")
Modell:	580	Breite:	9.33m (30'6")
Jahr:	2005	Tiefgang:	1.67m (5'5")
Rumpfmateriail:	GRP	Treibstoff:	795 Litres
Räumlichkeiten:	10 berths in 5 cabins	Wasser:	1.650 Litres
Designer:	Simonis Voogd	Motoren:	2 x 75hp Yanmar
Verdrängung:	17.96 tonnes		

690.000 US\$ MWSt nicht bezahlt



MOTOREN:

2 x 75hp Yanmar

Motorstunden: 1390 aprox.

FASSUNGSVERMÖGEN:

Treibstoff: 795 Litres

Wasser: 1650 Litres

MECHANISCHE AUSTRÜSTUNG:

Watermaker 1500 GPD Sea Recovery

PLUMBING:

4 x Automatic electric bilge pumps with alarms

2 x Manual bilge pumps

2 x Calorifiers 40 liters each (hot water system)

Self draining cockpit

2 x Pressurised hot and cold deck showers

Deck wash pump system with faucet in engine room and chain locker

2 x Black water systems and holding tanks

HATCHES AND WINDOWS:

8 x Reflective laminated glass windows

30 x Lewmar hatches

12 x Ocean Air Sky hatch screens

14 x Lewmar port lights

Aluminum framed sliding door with toughened glass

ENGINE EQUIPMENT:

Fresh water cooled Yanmar Turbo diesel engines

Sound insulation

2 x Instrument panels with engine hour meters

2 x 55A alternators

Fixed two blade propellers

High pressure fuel line

Engine spares

Tool kit

ELECTRICS:

2 x Engine start batteries 12V @ 110AH

Gel cell ships load batteries 24V @ 600AH

Alternators, additional 2 x 190A Ample Power Alternators with Smart Multi stage regulators with double belts

Circuit breaker panel

Battery Manager BTM single bank

Mastervolt Inverter 24V to 110V - 2.5kW

Battery charger 24V - 75Amp

Battery isolator switches

Light upgrade - dimmers, courtesy lights, spreader lights and boom lights, 12V outlets

Ceiling lights

Engine compartment lights

1 x Deck light

5 x Cockpit lights

13 x Interior 110V outlets

1 x 50A/110V shore cable socket

Shore cable 1 x 50A

Mast top and lower navigation lights



Steaming light

12V and 110V outlet in engine rooms

GENERATOREN:

2 x Generators 6kW Northern Lights (3602hrs)

RÄUMLICHKEITEN:

Berths: 10

Cabins: 5

Head: 6

Crew Berths: 0

Crew Cabins: 0

Luxurious bar with panoramic view

Gourmet galley and saloon

Large shaded cockpit

Five large queen size cabins

En-suite bathrooms with separate shower stalls

Electric fresh water toilets Par-Jabsco Silent Flush

On the layout of the **Voyage 580** the foredeck crew cabin has been converted to a laundry room with shelves, washing machine and dryer. This room can be reconverted back to a crew cabin.

As an alternative the starboard mid-ship en-suit cabin can be used as a crew cabin.

The middle cabin on the port side has been removed and the space has been used to increase the size of the master cabin, a small office/dressing room and space on the galley side for extra storage.

INNENAUSSTATTUNG:

MAIN SALOON:

Upholstered settee

Fan White Hella Turbo

Standing height throughout 1,9m

Saloon coffee table with adjustable height

GRP moulded finish to modules

Head Liner

Bar with seating for four

Surround Sound System 110V Bose Life Style

2 x Speakers on the lower spreaders

Radio/CD/DVD/MP3/Amplifier

Selection of 20 CD/DVD's

Television 26" Sharp flat screen

Semi-translucent window screens

Saloon appointments

FORWARD AND AFT EN-SUITE CABINS:

Full queen size bunk with split mattresses

2 x Fans White Hella Turbo

Television Sharp 17" flat screen

Sony Playstation/CD/DVD Player

GRP moulded finish to modules

Head liner

Cabin and reading lights

Upholstered seat cover

Stainless steel towel rails

Vanity table/writing desk in forward port cabin (owner cabin)

Wash basin pressurized hot and cold fresh water

Electric fresh water toilet Par-Jabsco Silent Flush

Separate shower with pressurised hot and cold water



Hanging and storage cupboards

2 x Mirrors

Soap dispenser

GRP molded finish to modules

Acrylic surfaces

Stainless steel towel rail

Loose lay carpets

Cabin appointments

STARBOARD MID-SHIP EN-SUITE CABIN:

Full queen size bunk with split mattress

2 x Fans White Hella Turbo

Television Sharp 17" flat screen

Sony Playstation/CD/DVD Player

GRP molded finish to modules

Head liner

Cabin and reading lights

Laundry locker with upholstered seat covers

Stainless steel towel rails

Wash basin

Electric fresh water toilet Par-Jabsco Silent Flush

Shower with pressurised hot and cold water

Cupboard

Mirror

Soap dispenser

GRP molded finish to modules

Acrylic surfaces

Loose lay carpet

Cabin appointments

DAY HEAD:

Vanity cabinet

Stainless steel towel rail

Wash basin

Electric fresh water toilet Par-Jabsco Silent Flush

Shower with pressurised hot and cold water

Soap dispenser

Cupboard

Cabinets

FOREDECK CREW CABIN:

Washer/Drier facility, 110V Outlet, water supply, overboard dump

KLIMAANLAGE:

Throughout

KOMBÜSE/WASCHKÜCHE:

Miele dishwasher

4 Burner stove

Gourmet stainless steel oven with rotisserie

Microwave oven

2 x Stainless steel sinks

Large recessed drip tray

Pressurised hot and cold water

Soap dispenser

Fan White Hella Turbo



Ventilating hatch in floor with teak grid
Front opening refrigerator 24V Adler Barbour PowerPlate
Top opening Freezer with 2 x 24V Adler Barbour PowerPlate's
GRP moulded finish to modules
Head liner
Large Acrylic work surfaces with stainless steel rails and fiddles
2 x Stainless steel waste chutes with covers
Galley appointments

BAR:
110V Ice Maker U-line
Front opening refrigerator 24V Adler Barbour PowerPlate
8 x Liquor dispensers with star lights Optics
Wine glass overhead storage rack
Tumbler glass shelf
Wine bottle storage locker
Acrylic work surface

NAVIGATION:

NAVIGATION CENTRE:

Recessed chart table with chart stowage
Instrument mounting panel
Navigation seat
Access panels to electrical installation
12V and 110V outlet

INSTRUMENTATION:

Compass
Raymarine E 120 Radar/Chart plotter 2kW 24nm with 8" repeater (RC 520 Plus E32034) in saloon
Raymarine Active heading sensor 150G Corepack with Rate Gyro and AST
Raymarine ST 6001 Autopilot with 24V Whitlock Rotary Drive
Raymarine ST 600R Autopilot remote control
Raymarine ST 60 Tridata & Wind
ICOM IC-M45 VHF Radio
ICOM 802 SSB Radio with AT140 antenna tuner including DSC
Handheld VHF ICOM-IC-M1

DECK:

DECK FITTINGS:

Stainless steel, Grade 316
Bow pulpits with seats
Outer pushpits on stern
Brackets for two life ring buoys
Brackets for two overboard lights
Stanchions and stanchion bases with rollers for furling control lines
2 x Swim ladders
Grab rails on coach roof and sides
Double guard wires with gates

DECK EQUIPMENT:

2 x Electric Primary winches on coach roof Andersen (1 x 58SB, 1 x 62SB)
1 x Main Sheet winch on coach roof Andersen 52ST
2 x Electric Secondary winches in cockpit Andersen 58STE
1 x Lofrans electric windlass
Harken Black Magic blocks
Harken Tracks and cars



Lewmar Jammers

10 x Aluminum mooring cleats

COCKPIT / DIVE PLATFORM / FOREDECK:

Steering console with stainless steel steering wheel and instrument console

10 x Storage lockers with GRP lids

4 x Storage lockers with hatches

2 x Dive tank lockers for six tanks each

Double 'Swivel Away' Helmsman's seat

2 x GRP cockpit tables

2 x Waterproof speakers in cockpit

Teak dive platform at stern

Propane gas supply, quick coupler with hose, solenoid switch and stainless steel post

2 x Propane Bar-B-Q (Parker Grill) on dive platform

Teak walkway between trampolines

Refrigerator 24V Adler Barbour PowerPlate with hatch

Hand basin with pressurized hot and cold fresh water

Traveller arch with hard top bimini and spray dodger

Rear and side bimini skirts

Stainless steel grab rail

Walk through from dive platform to cockpit

3 x Sheet and utility pouches

Cockpit cushions

Cockpit appointments

SPORT EQUIPMENT:

7 x 50 Binoculars Waterproof Fujinon

6 x Sets of Scuba equipment including tanks

1 x Malibu Double Seater Sea Kayaks

Fishing tackle

O'Brien Wake Board with bindings

O'Brien Celebrity Combo Ski's, Ski Rope with 2 x life vests

O'Brien Delta Dart Tube

15 x Snorkeling Masks, Snorkels, Fins and Bags

Sunning Cushions

Windsurfer

MOORING GEAR AND GROUND TACKLE:

60kg Delta anchor

90m anchor chain and 60m nylon anchor rods

Fortress F37 secondary anchor with 10ft chain

Para-tech Sea anchor rode with swivel (24ft)

SPIEREN, RUNDHÖLZER & SEGEL:

7/8th fractional rig and compression strut - Anodized aluminum mast, boom and cross beam Spinnaker

Mast supported by triple spreaders, intermediate and cap shrouds 2 x reefing lines with 2 x luff

pendants Navigation lights VHF antenna TV antenna on mast Lazy jacks Telescopic Boom Derrick system

Double purchase main halyard Mainsheet 2 x Flag halyards Profurl Genoa roller furler Profurl Screacher

roller furler Fully battened main, 3 x reef points, High Aspect cross cut Dacron with laminated leech

Harken Battcar system for Mainsail Furling Genoa cross cut High Modulus Dacron Bowsprit complete with

furling headsail (Screacher) Mainsail Stowage Pack Sheets and control lines

SICHERHEIT:

Flares

Life jackets

EPIRB



Buoys

First aid kit

Liferaft for 8 persons

BEIBOOTE/SPIELZEUG:

15ft rigid bottom tender with centre console and Yamaha 60hp four stroke HETOL

WARTUNGSGESCHICHTE UND BAUWEISE:

HULL DECK AND BULKHEADS:

Hand laid-up GRP construction using multi layers of Quadraxial glass roving, isophthalic and orthophthalic polyester resin and other highest grade material

Carbon Fiber with Epoxy resin for structural reinforcing at Chain plates, coachroof, arch and mast bulkhead and ring frame

Closed cell PVC foam core, vacuum bonded for stiffness, strength and minimal weight

Marine ply and balsa core on critical structure for added strength and stiffness

Additional reinforced areas for rudders, keels, and deck fittings

Forward water tight compartments with horizontal bulkheads

Skeg supported rudders

Reinforced low aspect keels

Antifouling over Epoxy based osmosis barrier

ANMERKUNGEN DES MAKLERS:

This **Voyage 580** can luxuriously accommodate up to ten guests offering five queen size cabins with full air conditioning and en-suite bathrooms with a separate stall shower. The saloon features a Surround Sound System Bose and a flat screen TV with a DVD and CD player. There are also stereo speakers in the cockpit and on the mast. Each cabin is equipped with its own flat screen TV and DVD player. The sails are in good condition. Professionally maintained.

STANDORT:

Caribbean





Grundriss

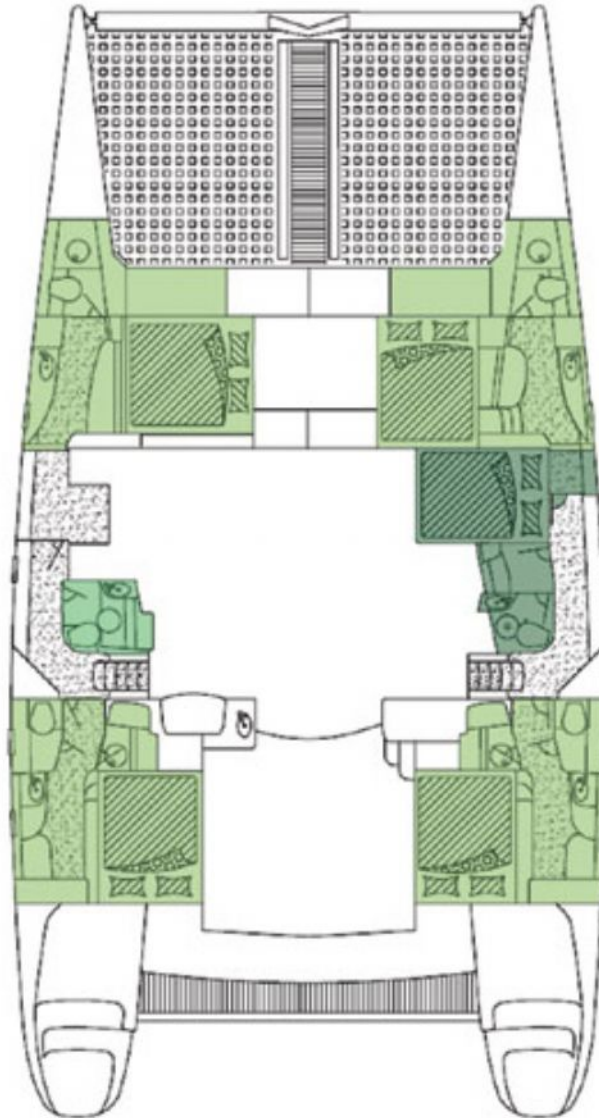

Die Angaben in dieser Beschreibung werden als korrekt angenommen, ihre Exaktheit ist jedoch weder garantiert noch können sie als Vertragsbestandteil genutzt werden. Ein unabhängiges Gutachten ist immer empfehlenswert. Dieses Schiff wird angeboten unter Vorbehalt von Zwischenverkauf, Preisänderung oder Angebotsrücktritt ohne Mitteilung.